

OPERATION, PARTS AND SAFETY MANUAL



SIGNODE®

**DF-16A
STRAP DISPENSER**

**IMPORTANT!
DO NOT DESTROY**

It is the customer's responsibility to
have all operators and servicemen
read and understand this manual.

Contact your local Signode representative
for additional copies of this manual.

READ ALL INSTRUCTIONS BEFORE OPERATING THIS SIGNODE PRODUCT

SIGNODE • 3620 WEST LAKE AVENUE • GLENVIEW, ILLINOIS 60025

⚠️ WARNING

READ THESE INSTRUCTIONS CAREFULLY.

FAILURE TO FOLLOW THESE INSTRUCTIONS CAN RESULT IN SEVERE PERSONAL INJURY.

GENERAL SAFETY CONSIDERATIONS

1. EYE INJURY HAZARD.

Failure to wear safety glasses with side shields can result in severe eye injury or blindness. Always wear safety glasses with side shields which conform to ANSI Standard Z87.1 or EN 166.



2. CUT HAZARD.

Handling strap or sharp parts could result in cut hands or fingers. Wear protective gloves.



3. TRAINING.

This dispenser must not be used by persons not properly trained in its use. Be certain that you receive proper training from your employer. If you have any questions contact your Signode Representative.

4. DISPENSER CARE.

Take good care of this dispenser. Inspect and clean it weekly. Replace any worn or broken parts.

5. WORK AREA.

Keep work areas uncluttered and well lighted.

SAFETY PROCEDURES FOR DISPENSER OPERATION

Before loading a coil of strap into the dispenser, read the loading and safety instructions.

- 1. Install dispenser properly before using it.**
- 2. Maintain proper footing and balance when loading dispenser.**
- 3. Do not load dispenser when you are in an awkward position. Use proper lifting techniques when loading a coil of strap into the dispenser.**
- 4. When mounting dispensers on wall and/or columns, use the proper Signode suspension brackets.**

CUTTING TENSIONED STRAP

Use only cutters designed for cutting strap; never use claw hammers, crowbars, chisels, axes or similar tools. Such tools will cause the strap to fly apart with hazardous force. Before using any Signode product read its Operation and Safety manual.

TABLE OF CONTENTS

General Safety Instructions	2
Specifications	3
Loading a Coil of Strap	4
Parts List	5

DF-16A DISPENSER Part No. 422300

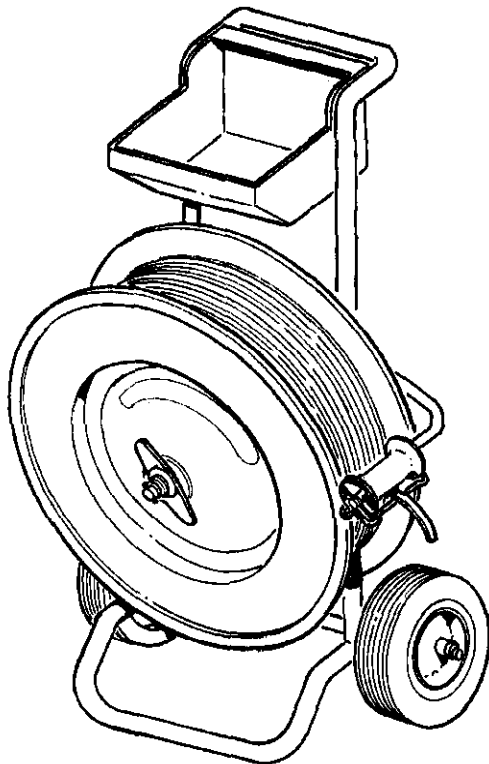

DF-16A, FRONT

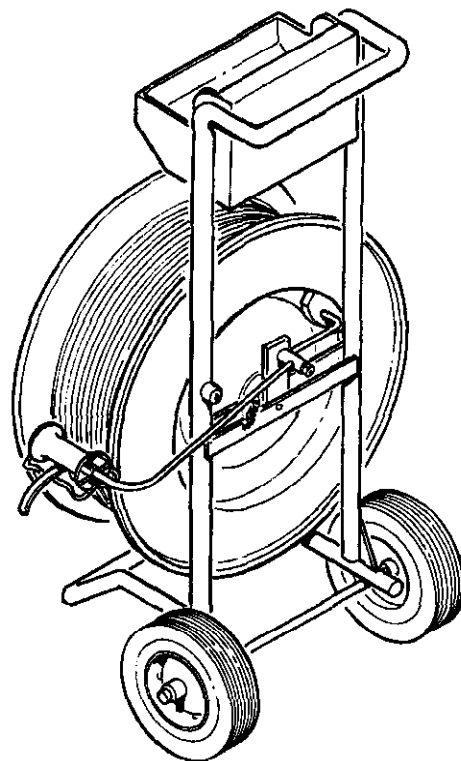

DF-16A, BACK

SPECIFICATIONS

MODEL	STRAP		COIL	
	TYPE	WIDTH	WIND	FACE WIDTH
DF-16A	PLASTIC	3/8" TO 5/8"	MILL WOUND	6"

LOADING AND THREADING INSTRUCTIONS FOR PLASTIC STRAP

To load a coil of plastic strap follow the steps below:

1. Carefully lay the dispenser on its back and remove the wing nut by turning it counterclockwise. Remove the outer reel disc assembly.
2. If applicable, remove the paper core and any plastic shrink film residue left over from the previous coil.
4. Place the coil of strap on the hub reel disc assembly.
5. Reinstall the outer reel disc assembly. Install and securely tighten the wing nut.

WARNING

Coils of plastic strap are heavy. Use proper lifting techniques to avoid personal injury.

3. Position the new coil of strap so that the arrows printed on the corrugated belly-band point in the same direction as the arrow on the inner reel disk. Pay-off rotation must be in the clockwise direction.

CAUTION

The wing nut must be tight, otherwise the wraps of the strap can become entangled.

6. Pull the plastic film from the coil, remove the corrugated belly-band and remove the tape that secures the lead end.
7. Thread the lead end of the strap through the brake arm roller and keeper (refer to threading diagram below), and raise the dispenser upright.

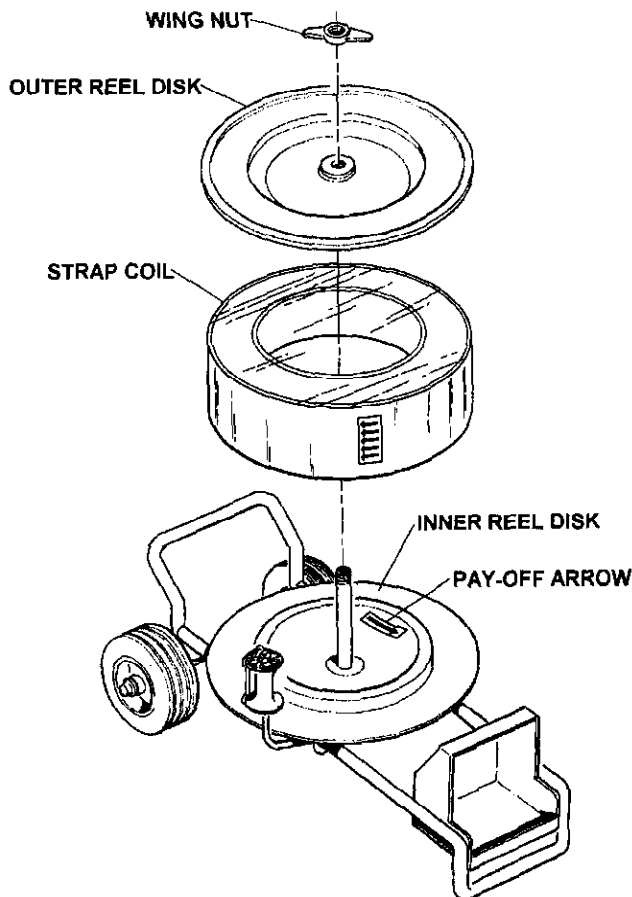

DF16A THREADING DIAGRAM

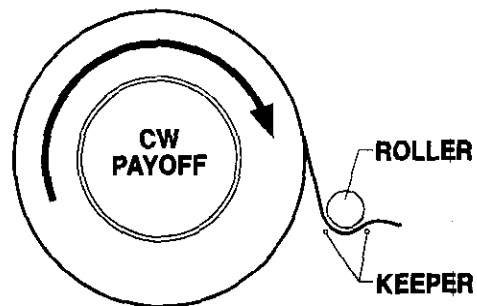

PARTS LIST, DISPENSER, 422300

KEY	QTY.	PART NO.	DESCRIPTION
1	1	422285	Dispenser frame
2	1	422289	Hub reel disc assembly
3	1	422291	Reel disk assembly
4	1	422292	Brake arm assembly
5	2	422307	Wheel
6	2	273720	Pallnut
7	1	006787	Roll pin, 3/16 x 1
8	1	024346	Spring
9	1	422296	Flat washer SAE, 3/8
10	1	080269	Locknut, 3/8-16
11	1	002897	Wing nut
12	1	422284	Identification label
13	1	024301	Bumper
14	2	422297	Needle bearing
15	1	024315	Directional arrow
16	1	091873	SHCS, 1/4-20 x 2
17	1	015137	Flex pull locknut, 1/4-20
18	1	002187	Lockwasher

WARNING

All parts must be periodically inspected and replaced if worn or broken. Failure to do this can affect a product's operation and can result in personal injury.

- When ordering parts, please show model, part number and description.
- Standard hardware parts may be obtained from any local hardware outlet.

** NOTE: Directional arrow (Key 15) must be applied to hub reel disk assembly (Key 2) pointing in the clockwise pay-off direction.

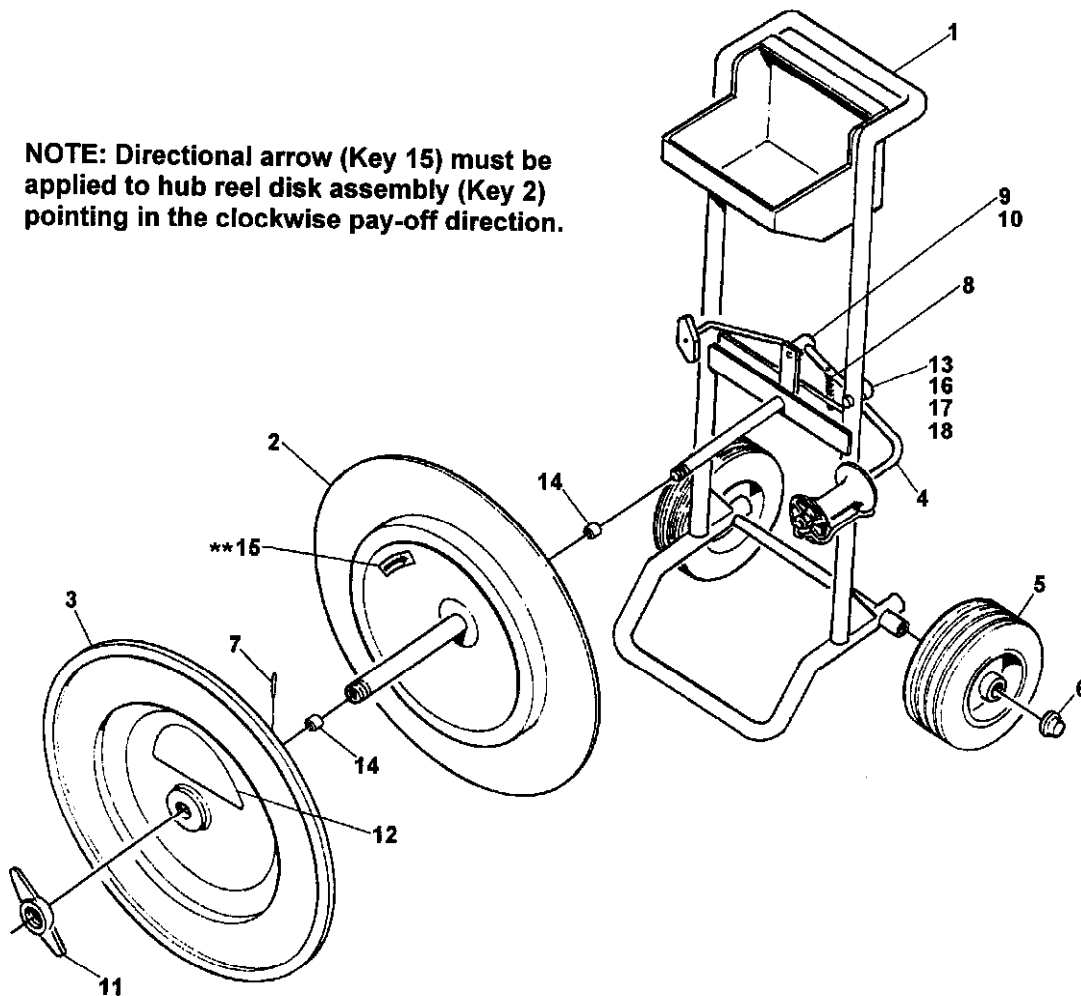

PARTS LIST, BRAKE ARM, 422292

<u>KEY</u>	<u>QTY.</u>	<u>PART NO.</u>	<u>DESCRIPTION</u>
1	1	422295	Brake pad
6	1	004693	Locknut
7	1	422294	Roller
8	1	422293	Keeper
9	1	422342	Brake arm weldment

- When ordering parts, please show model, part number and description.
- Standard hardware parts may be obtained from any local hardware outlet.

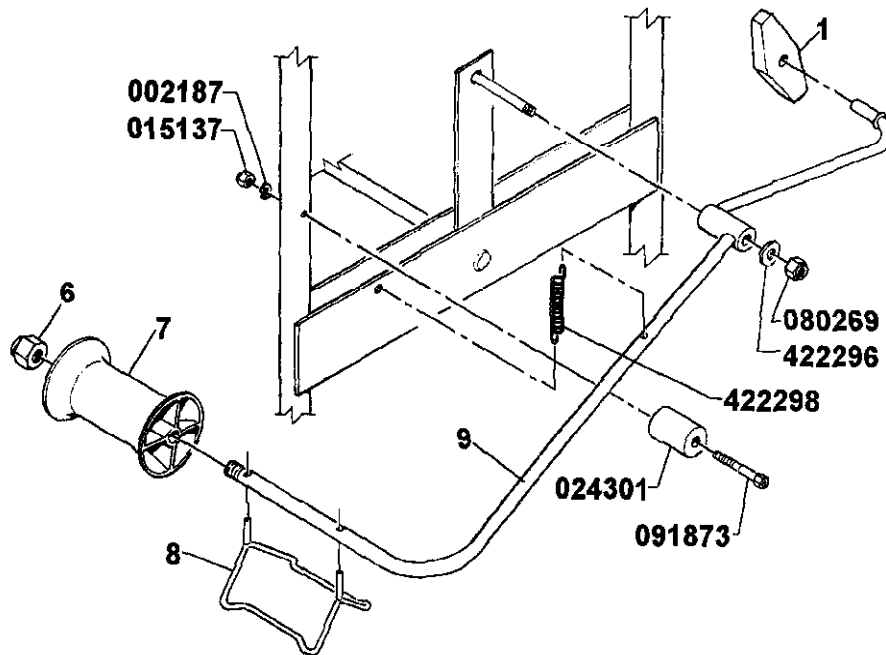

⚠ WARNING

All parts must be periodically inspected and replaced if worn or broken. Failure to do this can affect a product's operation and can result in personal injury.

SIGNODE NEW TOOL WARRANTY

Signode Engineered Products Warrants that a new Signode strapping tool will operate per functional specifications for a period of sixty (60) days after the date of shipment to the owner's place of business. Normal wearing parts, as outlined in the Operation, Parts & Safety manual, are covered by a thirty (30) day warranty unless, in Signode's judgement, these parts have been subjected to abnormal or extreme usage. Signode's sole liability hereunder will be to repair or replace, without charge, F.O.B. Signode's Glenview, Illinois plant, any tool which proves to not operate per functional specifications within the stated period. Signode reserves the right to replace any tool which proves not to operate per functional specifications with a new or like-new tool of the same model if in Signode's judgement such replacement is appropriate. Any new replacement tool provided to an owner will carry a full sixty (60) day warranty. Any warranty repaired tool or like-new replacement tool will carry a warranty for the balance of the time remaining on the initial sixty (60) day warranty. This warranty will be extended to compensate for the time the tool is in Signode's possession for warranty repairs.

This warranty is void as to any tool which has been: (I) subjected to mis-use, misapplication, accident, damage, or repaired with other than genuine Signode replacement parts, (II) improperly maintained, or adjusted, or damaged in transit or handling; (III) used with improperly filtered, unlubricated air or improper strapping material, (IV) in Signode's opinion, altered or repaired in a way that affects or detracts from the performance of the tool.

SIGNODE MAKES NO WARRANTY, EXPRESSED OR IMPLIED, RELATING TO MERCHANTABILITY, FITNESS OR OTHERWISE EXCEPT AS STATED ABOVE AND SIGNODE'S LIABILITY AS ASSUMED ABOVE IS IN LIEU OF ALL OTHERS ARISING OUT OF OR IN CONNECTION WITH THE USE AND PERFORMANCE OF THE TOOL. IT IS EXPRESSLY UNDERSTOOD THAT SIGNODE SHALL IN NO EVENT BE LIABLE FOR ANY INDIRECT OR CONSEQUENTIAL DAMAGES INCLUDING, BUT NOT LIMITED TO, DAMAGES WHICH MAY ARISE FROM LOSS OF ANTICIPATED PROFITS OR PRODUCTION, SPOILAGE OF MATERIALS, INCREASED COSTS OF OPERATION OR OTHERWISE.

Considerable effort has been made to ensure that this product conforms to our high quality standards. However, should you experience any difficulties, please contact your Sales Representative providing samples and the manufacturing code specified on the tool.

Thank you for your help.

SIGNODE ENGINEERED PRODUCTS
Hand Tool Division
3620 W. Lake Avenue, Glenview, Illinois 60025